

# HDCVI Mini PTZ Dome

2MP 4x PTZ HDCVI Camera



## HDCVI

- Max 60fps@720p and 30fps@1080p
- Powerful 4x Optical Zoom
- True WDR (120 dB)
- HD and SD Switchable
- IP66 Ingress Protection
- Vandal Resistant IK10



### System Overview

The 2-megapixel resolution, Pan/Tilt/Zoom (PTZ) camera with a 4x optical zoom lens adopts a high performance sensor, providing clear images with abundant details and exceptional color rendition. The camera features a HD/SD dual-output and a multi-language OSD.

### Functions

#### Multi-language OSD

The OSD menu provides various configurations for common monitoring requirements. The camera supports 10-language OSD including: Chinese, English, French, German, Spanish, Japanese, Korean, Russian and Polish.

#### Simplicity

HDCVI blends high quality images, affordability, and ease of use by utilizing traditional analog technology. Dahua HDCVI cameras are designed to make installation easy for a seamless upgrade from traditional analog without replacing existing coaxial cabling. The plug and play approach enables full HD video surveillance without the hassle of configuring a network.

#### Environmental

With a temperature range of  $-30^{\circ}\text{C} \sim +60^{\circ}\text{C}$  ( $-22^{\circ}\text{F} \sim +140^{\circ}\text{F}$ ), the camera is designed for extreme temperature environments. The camera complies to an IK10 impact rating making it capable of withstanding the equivalent of 55 kg (120 lbs) of force. Subjected and certified to rigorous dust and water immersion tests, the IP66 rating makes it suitable for demanding applications.

## Technical Specification

### Camera

Image Sensor	1/2.7" CMOS
Effective Pixels	1920 (H) x 1080 (V), 2 MP
Scanning System	Progressive
Electronic Shutter Speed	1/1 ~ 1/30,000s
Minimum Illumination	Color: 0.05Lux@F1.6; B/W: 0.005Lux@F1.6;
S/N Ratio	More than 55dB

### Lens

Focal Length	2.7mm~11mm (4x Optical zoom)
Max Aperture	F1.6
Angle of View	H: 112.5°~30°
Focus Control	Auto / Manual
Close Focus Distance	100mm~ 1000mm

### PTZ

Pan/Tilt Range	Pan: 0° ~ 355° endless; Tilt: 0° ~ 90°
Manual Control Speed	Pan: 0.1° ~100° /s; Tilt: 0.1° ~60° /s
Preset Speed	Pan: 100° /s; Tilt: 60° /s
Presets	300
PTZ Mode	8 Tour, Auto Scan
Speed Setup	Human-oriented focal length/ speed adaptation
Power up Action	Auto restore to previous PTZ and lens status after power failure
Idle Motion	Activate Preset/ Scan/ Tour/ Pattern if there is no command in the specified period
Time Task	Auto activation of Preset/ Pan/ Scan/ Tour/ Pattern by preset-time
Protocol	DH-SD, Pelco-P/D (Auto recognition)

### Video

Resolution	30fps@1080p, 30/60fps@720p
Video Output	1-channel BNC HDCVI high definition video output/ CVBS standard definition video output
Day/Night	Auto (ICR) / Color / B/W
BLC Mode	BLC / HLC / True WDR (120 dB)
White Balance	Auto, ATW, Indoor, Outdoor, Manual
Gain Control	Auto / Manual
Noise Reduction	Ultra DNR (2D/3D)
Digital Zoom	16x
Flip	180°

### Certifications

Certifications	CE: EN55032/EN55024/EN50130-4 FCC: Part15 subpartB,ANSI C63.4- 2014 UL: UL60950-1+CAN/CSA C22.2, No.60950-1
----------------	---

### Interface

Audio Interface	N/A
RS485	1
Alarm	N/A

### Electrical

Power Supply	DC12V, 1.5A
Power Consumption	18 W

### Environmental

Operating Conditions	-30°C ~ +60°C (-22°F ~ +140°F) Less than 90% RH
Storage Condition	-30°C ~ +60°C (-22°F ~ +140°F) Less than 90% RH
Ingress Protection & Vandal Resistance	IP66, IK10

### Construction

Casing	Metal
Dimensions	Φ122mm x 89mm (Φ4.80" x 3.50")
Net Weight	0.60 kg (1.32 lbs)
Gross Weight	0.65 kg (1.43 lbs)

## Ordering Information

Type	Part Number	Description
2MP Camera	DH-SD22A204IN-GC	2MP HD PTZ 4x Optical Zoom, True D/N, True WDR
Accessories	DC12V/2A	Power Supply
	PFB203W	Wall Mount Bracket
	PFB200C	In-Ceiling Mount Bracket
	PFA137	Water-proof Junction Box
	PFA152-E	Pole Mount Bracket

## Dimensions (mm/inch)

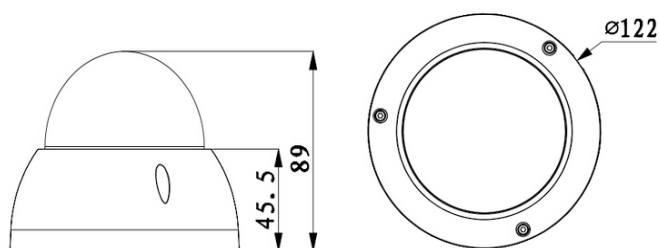

## Accessories

Optional:



Wall Mount	Ceiling Mount
PFB203W	PFB200C
Junction Mount	Pole Mount
PFA137	PFA152-E